

ANDERSON, C.E. ADD.	18
ANDERSON, JOHN H. ADD.	8-9
ARMSTRONG, CAROL & CO. ADD.	24-25
ARMSTRONG, WILLIAM H. ADD.	19
ARMSTRONG, W.M. Sub-Div. of Lot 19	18
ARMSTRONG Sub-Div. of Lot 19 (Plan 3rd)	18
ASTLEY ADD.	1-2
AVELLINO ADD.	3
BARNARD-COOPER ADD.	24
BARNARD-COOPER-HAMMOND ADD.	25-26-28
BARNARD 1st ADD.	25-28
BARNARD 2nd ADD.	24-25-26-27-28
BARNARD 3rd ADD.	24-25-26-27-28
BELLAIRE CITY PLAT	10-20
BELLAIRE PLAT of	11
BELLAIRE RAIL WORKS ADD.	24
BOYES ADD.	25-28
CHAMBER 1st ADD.	28
CHAMBER 2nd ADD.	28
CHAMBER 3rd ADD.	28
CHAMBER 4th ADD.	28-29
DAVIS ADD.	27-28
DUNFEE ADD.	11
EDGEHILL ADD.	11
ELKMAN REAL ESTATE ADD.	29-30-31
FINKS 1st ADD. (South Belleire)	10-11
FINKS 2nd ADD.	10
FINKS 3rd ADD.	10
FINKS 4th ADD.	10
FLORENCE ADD.	8
FOLMER-RONNIE ADD.	8
GRANDVIEW ADD.	9
GRANDVIEW & DUDLEYS ADD.	26
HARRIS FARM ADD.	11
HEATHERINGTONS 1st ADD.	10
HEATHERINGTONS 2nd ADD.	4-10
HEATHERINGTONS 3rd ADD.	4-10
HEATHERINGTONS 4th ADD.	3-4
HORN 1st ADD.	23-24
HULLY Sub-Div. of Lot 10	20-21
KENNEDYS ADD. To West Belleire	16
KEYSER, L.E. ADD. To Belleire (Block A)	6
KEYSER, L.E. ADD. To Belleire (Block B)	6
KEYSER, JOHN T. 2nd ADD.	6
LIWOOD ADD.	7-8-13-14-16-17
MORRIS 1st ADD.	21
MORRIS 2nd ADD.	21
PELLEYS LOTS	21
ROBINSON-ANDERSON-MELLOTT ADD.	14-15
ROBINSON & McCLAIN ADD.	21
ROCKBURN ADD.	1
ROOPER 1st.	20
ROOPER 2nd.	20
ROOPER 3rd.	20-24
ROSSER-ROBINSON 1st ADD.	22
ROSSER-ROBINSON 2nd ADD.	22
ROSSER-ROBINSON 3rd ADD.	22-23
SHRETS ADD.	24
SULLIVAN-BARNARD-COOPER ADD.	18-21
SULLIVAN-BARNARD-COOPER 2nd ADD.	18-21
SULLIVAN, Mrs. J.M. ROBEY ADD. of Out-Lot 1	18-19
SULLIVAN, Mrs. J.M. ROBEY ADD.	18
WEST BELLAIRE (Robinson-Anderson-Mellett)	14-15-16

CITY OF  
BELLAIRE  
BELMONT COUNTY  
OHIO

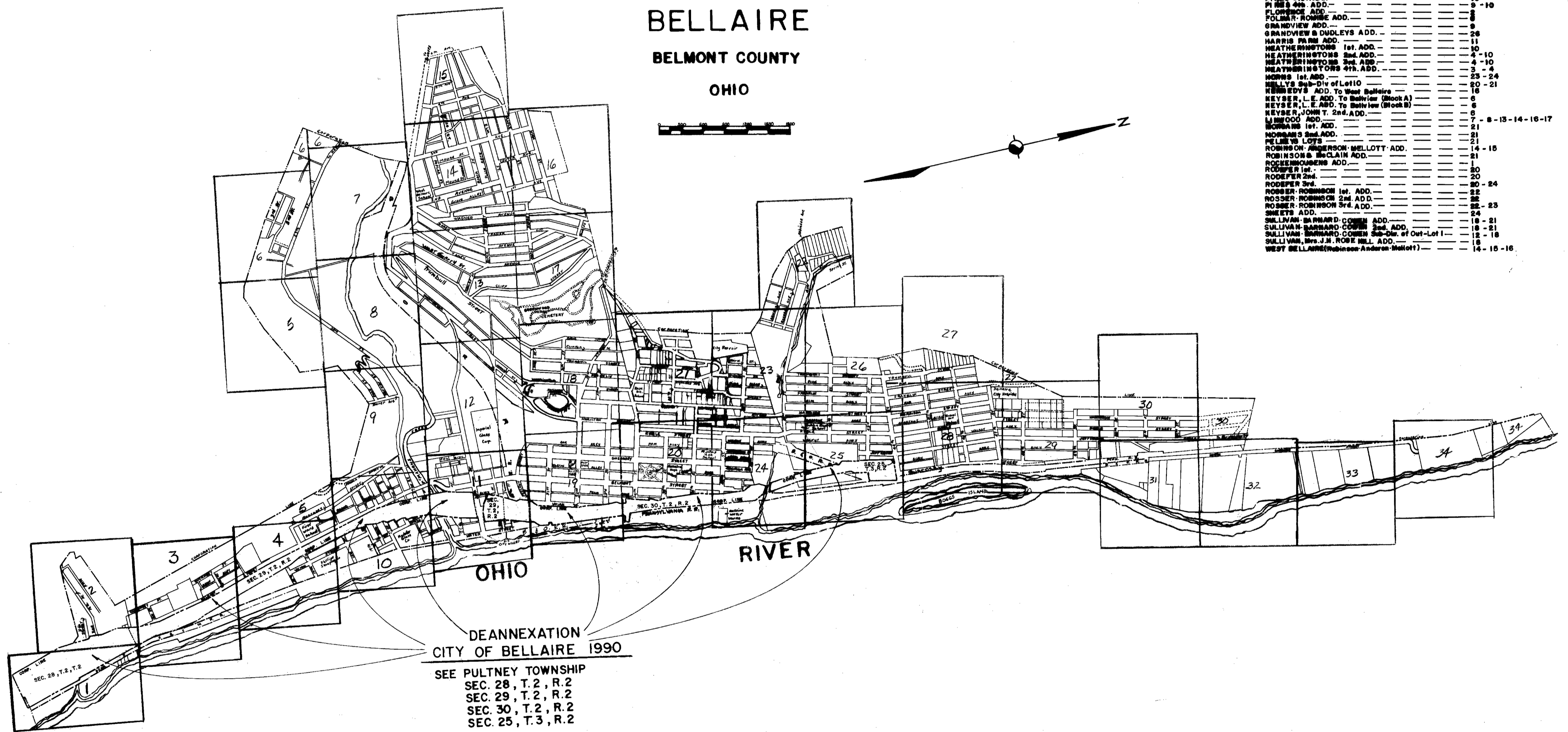
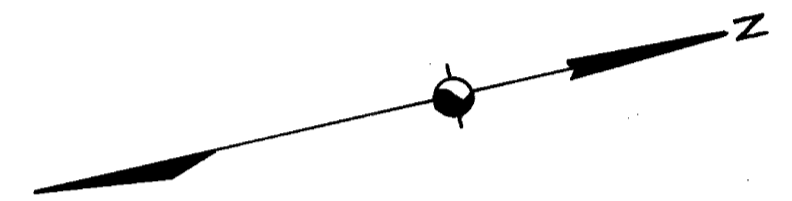
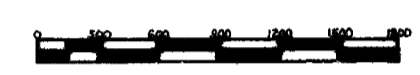

DEANNEXATION  
CITY OF BELLAIRE 1990  
SEE PULTNEY TOWNSHIP  
SEC. 28, T.2, R.2  
SEC. 29, T.2, R.2  
SEC. 30, T.2, R.2  
SEC. 25, T.3, R.2

FRED F BENNETT  
BELMONT COUNTY ENGINEER  
1966