

BELMONT COUNTY AUDITOR
 Transferred by Belmont County Auditor H. C. HALL
 Date Aug 8 1979 by Pat Castiglione Fee
 BELMONT COUNTY RECORDER
 No. 149348
 Received Aug 8 1979
 At 11 O'Clock A M.
 Recorded August 21 1979, in the Belmont County Plat Records
 Cab. D Slide 269
 # 25. FEE PAID
Stanley Simancia
 Recorder

OWNERS' CONSENT AND DEDICATION
 We, the undersigned, being the authorized agents of the Ohio Valley Mall Company, the company owners of the property represented by this plat, do for the said company, consent to the execution and recording of said plat, and do for said company dedicate for public use the streets shown hereon and state that we are duly authorized to do so.

Witnesses
Jerry P. Adams
June E. Casey
 Authorized Agent
 Notary Public

STATE OF OHIO
 Be it remembered that on this 10 day of August 1979, before me the undersigned, a notary public in and for said state, personally came Anthony Cafaro and Ronald Ramsey Authorized Agents of the Ohio Valley Mall Company who acknowledged that they did sign the foregoing plat and that the same is their free act and deed, in testimony whereof I have set my hand and notary seal on the above day and date.

Jerry P. Adams
 Notary Public in and for the State of Ohio

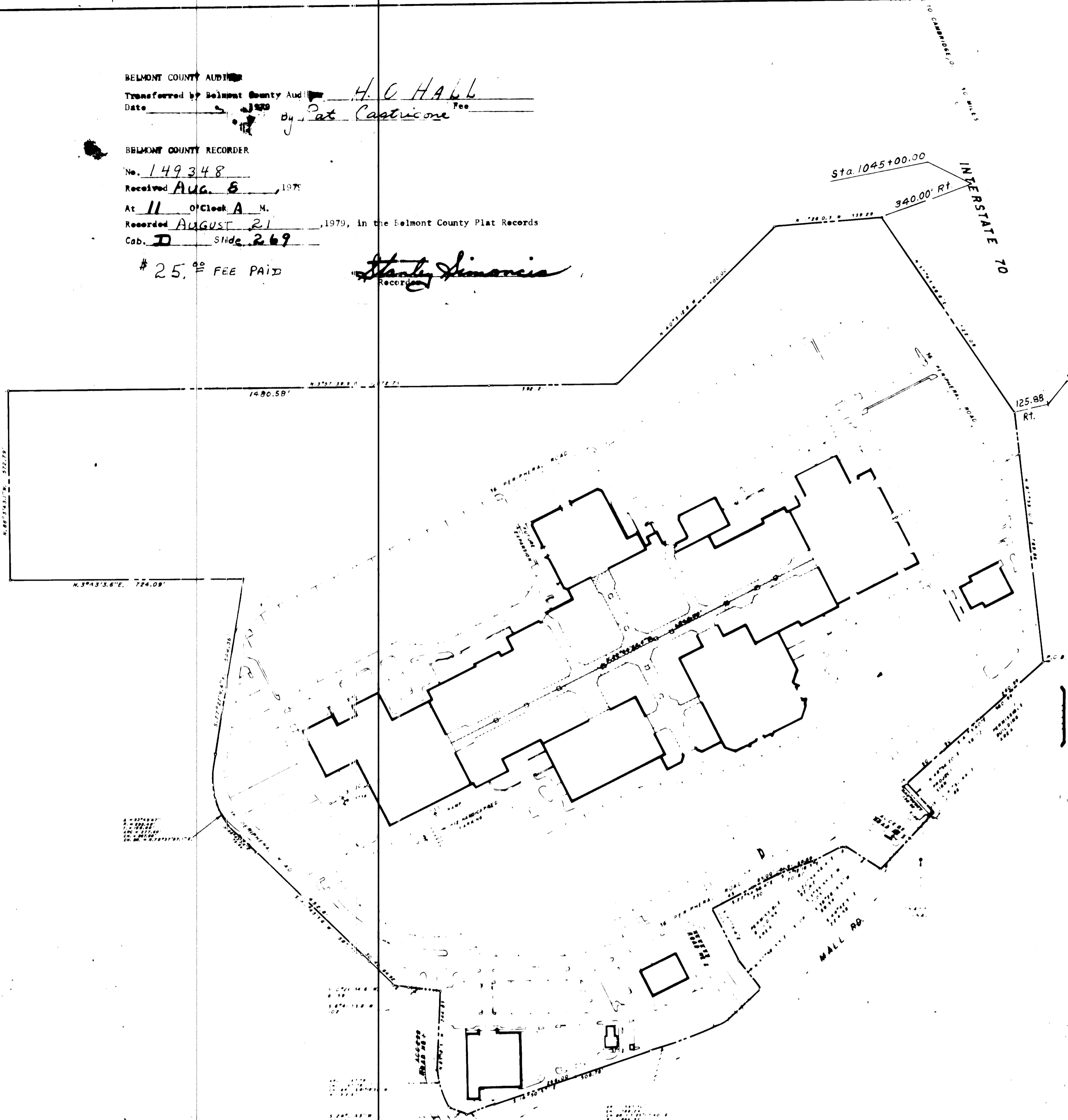

NOTE:
 Centerline of I-70 is Recorded in Cabinet "D" Slide 92 & 93 Belmont County Record of Plats

Approved by Belmont County Commissioners
8/8/1979
 Date A. J. Sargent
8/8/1979
 Date Charles Linck
8/8/1979
 Date Robert Olexo

DEED OF EXPLANATION RECORDED IN DEED VOL. 587, PAGE 411 OF THE BELMONT COUNTY RECORD OF DEEDS.

OHIO VALLEY MALL COMPANY PLAT
 Includes Portions of Replat of
 Grant (13,907 Acres), Saska (2,238 Acres), (Section 7, 1,488 Acres)
 DeVaughn (3,094 Acres) and Laurel Development (34,085 Acres)
 Situated in the Township of Mehlend, County of Belmont, and State of Ohio, and being more particularly described as follows:
 Being a part of the northwest quarter of Section 28, being a part of the southwest quarter of Section 28, being a part of the southeast quarter of Section 34, and being a part of the northwest quarter of Section 33, Township 6, Range 3;
 Beginning at a corner point being the northeast corner of Section 33, the southeast corner of Section 34, the southeast corner of Section 28, and the northwest corner of Section 27, Township 6, Range 3;
 Thence S 08°11'47" E along the common section line between Section 28 and Section 27, a distance of 396.00 feet to a point;
 Thence N 02°25'34.9" E, a distance of 544.01 feet to a point on the southerly right-of-way line of Interstate Route 70 and the true point of beginning of the parcel herein described;
 Thence S 41°03'40" E, a distance of 560.99 feet to a point;
 Thence N 48°56'20" E, a distance of 138.72 feet to a point, said point being on the west right-of-way line of Mall Road;
 Thence along the right-of-way line S 41°40'46" E, a distance of 104.00 feet to a point;
 Thence ~~along~~ along the right-of-way line S 41°41'38" E, a distance of 224.58 feet to a point;
 Thence S 39°28'15.5" W, a distance of 159.54 feet to a point;
 Thence S 3°39'55.2" W, a distance of 12.05 feet to a point;
 Thence S 22°54'56.4" E, a distance of 92.42 feet to a point;
 Thence S 17°12'18.3" E, a distance of 120.60 feet to a point;
 Thence S 22°54'56.4" E, a distance of 230.00 feet to a point;
 Thence N 05°05'04" E, a distance of 200.00 feet to a point;
 Thence N 37°58'15.5" E, a distance of 131.06 feet to a point, said point being on the west right-of-way line of Mall Road;
 Thence along the right-of-way line which curves to the right, said curve being an arc length of 390.30 feet, a radius of 1004.91 feet, a chord bearing of S 25°03'40" E, and a chord distance of 383.37 feet to a point;
 Thence S 14°50'57" E, a distance of 508.78 feet to a point;
 Thence along the right-of-way line which curves to the left, said curve being an arc length of 93.45 feet, a radius of 896.91 feet, a chord bearing of S 17°05'07" E, and a chord distance of 91.11 feet to a point;
 Thence S 24°02'43" W, a distance of 72.03 feet to a point on the north right-of-way line of Township Road #314 (Bank Road);
 Thence along the right-of-way line which curves to the right, said curve being an arc length of 167.79 feet, a radius of 117.51 feet, a chord bearing of S 81°18'36" W, and a chord distance of 81.79 feet to a point;
 Thence N 83°18'31" W, a distance of 244.85 feet to a point;
 Thence S 6°41'33.8" W, a distance of 102.00 feet to a point;
 Thence S 10°26'34.0" W, a distance of 61.39 feet to a point;
 Thence S 48°43'3.6" W, a distance of 134.92 feet to a point;
 Thence S 48°43'3.6" W, a distance of 452.81 feet to a point;
 Thence S 48°43'3.6" W, a distance of 75.58 feet to a point, said point being the beginning of a curve to the right;
 Thence along the curve to the right, said curve having a Δ of 53°49'47", a radius of 295.48 feet, an arc length of 277.60 feet, a chord distance of 267.50 feet, and a chord bearing of S 75°05'52" W, an arc distance of 277.60 feet to a point;
 Thence N 97°27'20" W, a distance of 548.36 feet to a point;
 Thence S 3°43'3.6" W, a distance of 724.09 feet to a point;
 Thence N 88°03'42.1" W, a distance of 572.79 feet to a point;
 Thence N 3°37'3.0" E, a distance of 187.79 feet to a point;
 Thence N 40°03'12.8" W, a distance of 700.00 feet to a point;
 Thence N 1°26'0.3" W, a distance of 339.29 feet to a point, said point being on the southerly limited access line of Interstate 70 opposite and 340.00 feet from centerline station 104300+00;
 Thence along the limited access line N 57°43'46.8" E, a distance of 722.09 feet to a point, said point being opposite and 125.88 feet from centerline station 105200+00;
 Thence along the limited access line N 17°55'40" E, a distance of 769.86 feet to the point of beginning, and containing in the interior 115.359 acres of land which are situated as follows:
 Section #22 - 63.184 Acres
 Section #28 - 9.453 Acres
 Section #33 - 33.800 Acres
 Section #34 - 8.922 Acres

BELMONT COUNTY ENGINEER
 Approved for Record Paul F. Bennett
 Belmont County Engineer
 Date Aug 8 1979

CERTIFICATE OF SURVEYOR
 I, Edwin D. Calverley, hereby certify that this map is a true and correct copy of the original plat as made by me on July 1, 1979, that all monuments are set as shown.

