

346.00 - 100 = 246

PLAT SHOWING EXTENSION OF THE CORPORATE LIMITS OF YORKVILLE · 1978

PREPARED BY JOHN T. McDEVITT · SURVEYOR · STEUBENVILLE, OHIO

CABINET - D SLIDE - 244

COPY OF JOURNAL ENTRY

IN THE MATTER OF ANNEXING TERRITORY TO THE VILLAGE OF YORKVILLE-OHIO
PETITION RECEIVED AND FILED: May 31, 1978 ON THIS DAY A MAJORITY OF THE OWNERS OF THE REAL PROPERTY PROPOSED TO BE ANNEXED PRESENTED TO THE COMMISSIONERS OF BELMONT COUNTY, A PETITION ASKING FOR THE AUTHORITY TO ANNEX TERRITORY TO THE VILLAGE OF YORKVILLE-OHIO, IN ACCORDANCE WITH SECTION 109.02 ET. SEQ. OF THE REVISED CODE OF OHIO. SAID PETITION WAS ACCEPTED BY THE COMMISSIONERS AND ORDERED FILED AND THE DATE OF HEARING OF SAID PETITION WAS SET FOR July 31, 1978 AT 10:00 IN THE OFFICE OF THE COUNTY COMMISSIONERS, ST. CLAIRSVILLE, OHIO.

YEA: A. J. Burgess
PRESIDENT OF BOARD

IN THE MATTER OF ANNEXING TERRITORY TO THE VILLAGE OF YORKVILLE-OHIO
COMMISSIONERS CONSENT GRANTED July 31, 1978

HEARING HAD

THIS BEING THE HOUR AT WHICH HEARING SHALL BE HAD IN THE ABOVE ENTITLED MATTER ACCORDING TO THE BOARD OF COUNTY COMMISSIONERS MADE ON July 31, 1978 AND THERE BEING NO OBJECTION TO THE PETITION AS PRESENTED AND IT APPEARING THAT IN ACCORDANCE WITH STATUTE SUFFICIENT NOTICE HAD BEEN PRINTED IN THE TIMES LEADER, THE CORPORATE LIMITS OF THE VILLAGE OF YORKVILLE WAS GRANTED AN EXTENSION IN A SOUTHERLY AND A EASTERLY DIRECTION FROM THE PRESENT CORPORATE LIMITS SO AS TO INCLUDE 144.76 ACRES COMPOSED OF SUCH TRACTS AS PER PETITION AND MAPS PRESENTED, SAID EXTENSION BEING AN EXTENSION TO THE PRESENT CORPORATE LIMITS.

YEA: A. J. Burgess
PRESIDENT OF BOARD

Charles O. Smith
CLERK OF BOARD

J. J. Hoffman
CLERK OF COUNCIL

CERTIFICATION

I HEREBY CERTIFY THE ABOVE TO BE TRUE COPIES OF THE JOURNAL ENTRIES PERTAINING TO THE ANNEXATION OF TERRITORY TO THE VILLAGE OF YORKVILLE, OHIO AS DESCRIBED IN THE PETITION PRESENTED TO THE COUNTY COMMISSIONERS.
RECORDED VOL. 89 PAGE 244 COUNTY COMMISSIONERS JOURNAL.

Charles O. Smith
CLERK OF BOARD OF COUNTY COMMISSIONERS

CLERK OF COUNCIL

I HEREBY CERTIFY THAT THE FOREGOING IS A TRUE TRANSCRIPT OF PROCEEDINGS FOR THE ANNEXATION OF THE TERRITORY DESCRIBED THEREIN.

SIGNED BY ME THIS 16th DAY OF October 1978

J. J. Hoffman
CLERK OF COUNCIL

CERTIFICATION

I HEREBY CERTIFY THAT THIS PLAT WAS PREPARED FROM AN ACTUAL SURVEY OF THE PREMISES, AND THAT THE SAME IS CORRECT TO THE BEST OF MY KNOWLEDGE.

John T. McDevitt, P.E., P.S.
JOHN T. McDEVITT REG. SURVEYOR NO. 5765

BELMONT COUNTY ENGINEER

APPROVED FOR RECORD
DATE Nov 14 1978

BELMONT COUNTY ENGINEER

BELMONT COUNTY AUDITOR

TRANSFERRED BY BELMONT COUNTY AUDITOR
DATE 11-14 1978

H. O. Hall
BELMONT COUNTY AUDITOR
BY P. Carbone D. AUD

BELMONT COUNTY RECORDER

NO. 144881
RECEIVED FOR RECORD Nov. 14 1978, AT 11:30 O'CLOCK
RECORDED DECEMBER 6 1978
BELMONT COUNTY RECORD OF PLATS CAB. D SLIDE 244
25.00
FEE PAID
Stanley Simonis
BELMONT COUNTY RECORDER

NOTE: BEARINGS FOR THIS PLAT ARE BASED UPON A SURVEY MADE BY THE OHIO DEPARTMENT OF TRANSPORTATION FOR RELOCATED STATE ROUTE #7 DESIGNATED AS SECTION BEL-7-23.74; JEF-7-0.00 AND RECORDED IN PLAT BOOK 13, PAGE 91 OF THE BELMONT COUNTY PLAT RECORDS.

ORDINANCE NO. 891-78

AN ORDINANCE ACCEPTING ANNEXATION OF CERTAIN CONTIGUOUS TERRITORY TO THE SAID VILLAGE OF YORKVILLE, STATE OF OHIO.

BE IT ORDAINED BY THE COUNCIL OF THE VILLAGE OF YORKVILLE, STATE OF OHIO.

SECTION 1: THAT THE ANNEXATION OF THE FOLLOWING DESCRIBED TERRITORY TO THE SAID VILLAGE OF YORKVILLE - BELMONT COUNTY - STATE OF OHIO, BE AND THE SAME IS HEREBY ACCEPTED TO WIT: SITUATED IN THE TOWNSHIP OF PEASE, COUNTY OF BELMONT, STATE OF OHIO, AND BEING A PART OF SECTIONS 14, 15, 20 AND 21, TOWNSHIP 4 NORTH, RANGE 2 WEST, AND BEING MORE PARTICULARLY DESCRIBED AS FOLLOWS: BEGINNING FOR A POINT ON THE SOUTH LINE OF SECTION 15 IN THE CENTERLINE OF SURVEY FOR RELOCATED STATE ROUTE #7; SECTION BEL-7-23.74; JEF-7-0.00 AS RECORDED IN PLAT BOOK 13, PAGE 91 OF THE BELMONT COUNTY PLAT RECORDS, SAID POINT BEING ON THE SOUTH CORPORATION LINE OF THE VILLAGE OF YORKVILLE; THENCE WITH THE SOUTH CORPORATION LINE OF THE VILLAGE OF YORKVILLE S 86°03'30"E 1015.39 FEET TO A POINT IN THE OHIO RIVER; THENCE WITH THE OHIO RIVER THE FOLLOWING TWELVE (12) COURSES AND DISTANCES:
(1) S 6°06'50"W 245.15 FEET
(2) N 7°12'53"W 11.19 FEET
(3) S 7°18'50"W 1331.61 FEET
(4) S 23°08'50"W 1090.46 FEET
(5) S 86°52'05"E 126.79 FEET
(6) S 23°19'30"W 1338.50 FEET
(7) N 05°51'51"W 144.50 FEET
(8) S 4°02'09"W 11.96 FEET
(9) S 05°51'51"E 40.63 FEET
(10) S 11°19'30"W 424.17 FEET
(11) S 83°03'30"E 108.00 FEET
(12) S 1°02'40"E 260.60 FEET
TO A POINT AT THE NORTHEAST CORNER OF THE CITY OF MARTINS FERRY CORPORATION LINE, THENCE WITH THE NORTH CORPORATION LINE OF THE CITY OF MARTINS FERRY THE FOLLOWING TWO (2) COURSES AND DISTANCES:
(1) S 81°32'20"W 1092.14 FEET
(2) S 44°28'20"W 28.99 FEET
TO A POINT ON THE EAST LIMITED ACCESS RIGHT OF WAY LINE FOR RELOCATED STATE ROUTE #7;

THENCE WITH THE EAST RIGHT OF WAY LINE FOR RELOCATED STATE ROUTE #7 THE FOLLOWING TWENTY-TWO (22) COURSES AND DISTANCES:
(1) N 7°20'23"E 42.90 FEET
(2) N 10°20'E 533.19 FEET
(3) N 26°43'02"E 64.92 FEET
(4) N 87°46'20"E 45.00 FEET
(5) S 6°20'04"E 131.59 FEET
(6) S 2°15'40"E 200.00 FEET
(7) N 01°46'20"E 110.00 FEET
(8) N 2°13'40"W 621.62 FEET
(9) N 05°51'51"W 5.03 FEET
(10) N 2°13'40"W 803.19 FEET
(11) WITH A CURVE TO THE RIGHT HAVING A RADIUS OF 7674.49 FEET, AN ARC LENGTH OF 455.35 FEET, A CHORD BEARING OF N 0°31'41"W AND A CHORD LENGTH OF 455.20 FEET TO A POINT ON THE SOUTH LINE OF SECTION 21
(12) S 06°52'05"E 5.00 FEET
TO A POINT ON THE SOUTH LINE OF SECTION 21
(13) WITH A CURVE TO THE RIGHT HAVING A RADIUS OF 7669.49 FEET, AN ARC LENGTH OF 1345.90 FEET, A CHORD BEARING OF N 6°11'52"E AND A CHORD LENGTH OF 1344.17 FEET
(14) N 07°41'40"W 66.80 FEET
(15) N 1°40'24"E 275.02 FEET
(16) WITH A CURVE TO THE RIGHT HAVING A RADIUS OF 7705.49 FEET, AN ARC LENGTH OF 338.81 FEET, A CHORD BEARING OF N 14°23'57"E, AND A CHORD LENGTH OF 338.80 FEET
(17) N 72°47'58"W 67.75 FEET
(18) N 4°21'51"E 318.11 FEET
(19) N 4°50'23"E 285.53 FEET
(20) S 05°38'47"W 54.36 FEET
(21) WITH A CURVE TO THE RIGHT HAVING A RADIUS OF 200.44 FEET, AN ARC LENGTH OF 38.05 FEET, A CHORD BEARING OF S 09°21'50"W, AND A CHORD LENGTH OF 38.05 FEET
(22) N 25°10'06"E 68.05 FEET
TO THE TRUE PLACE OF BEGINNING; CONTAINING 144.76 ACRES, MORE OR LESS.

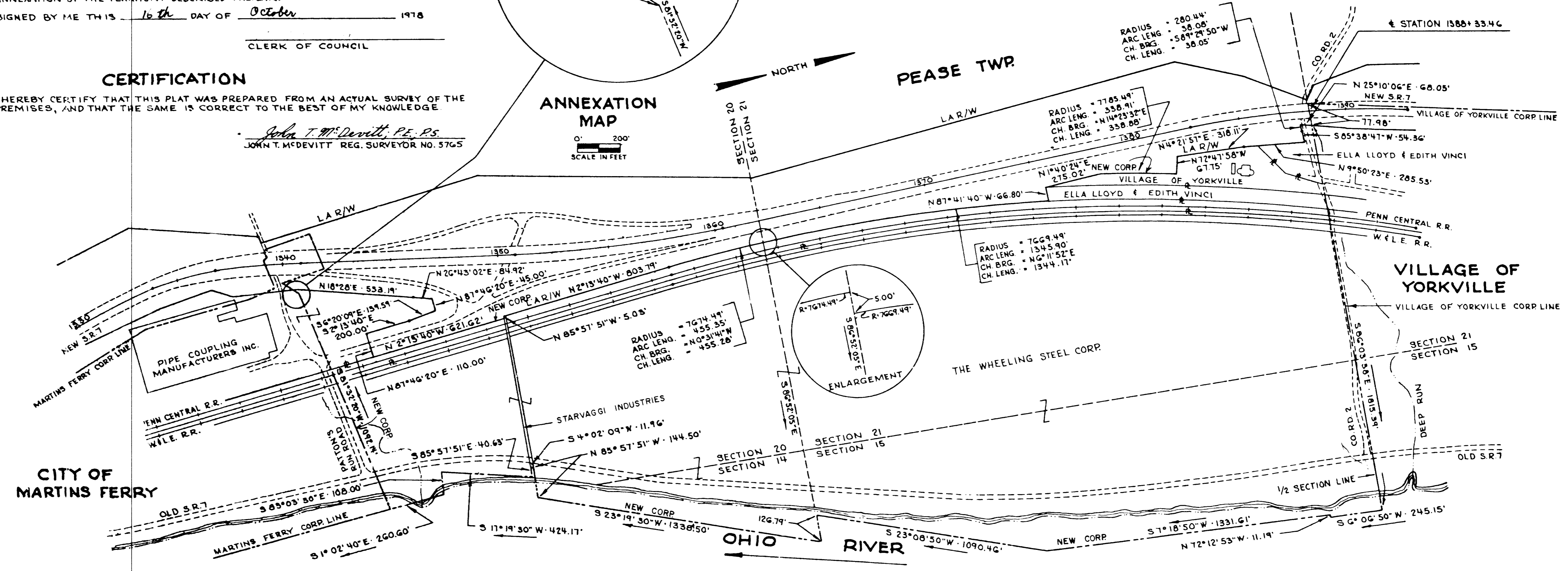
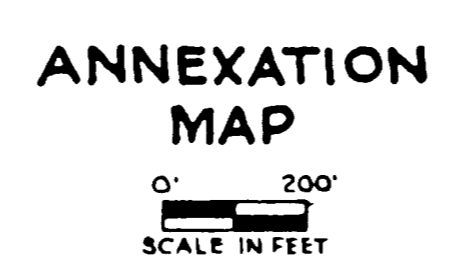
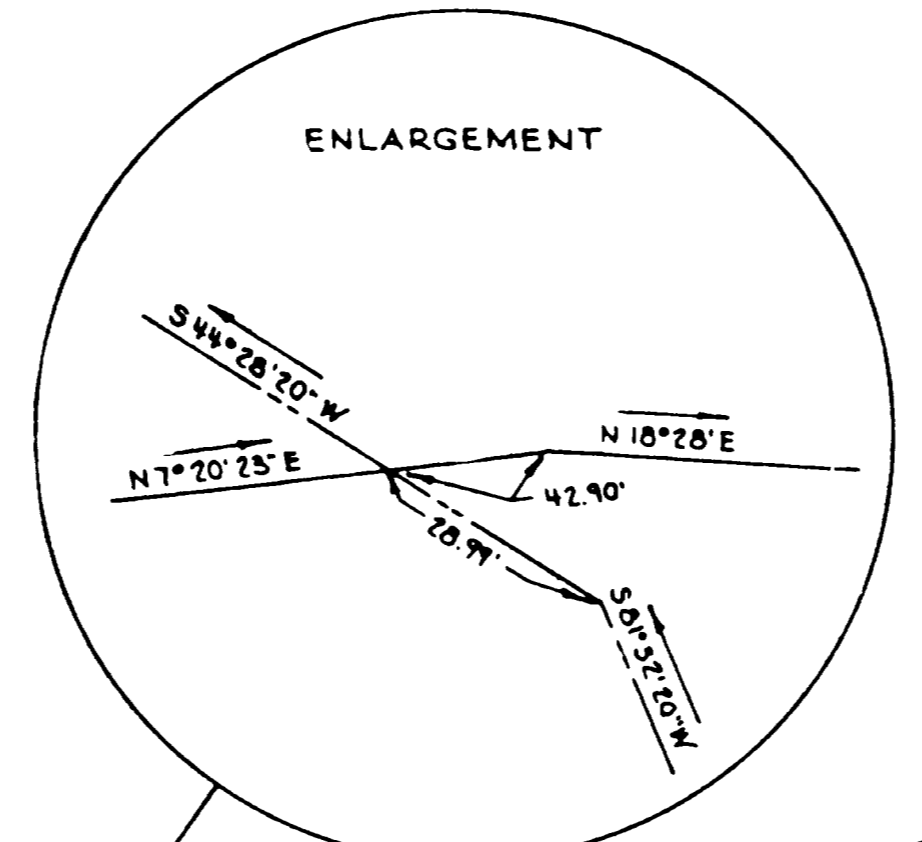

PROPERTY SUMMARY			
NAME	VOLUME	PAGE	AREA IN ANNEXATION
VILLAGE OF YORKVILLE	41G	535-582	2.70 AC.
PENN CENTRAL R.R. CO.			6.49 AC.
W & L E. R.R. CO.			4.32 AC.
PIPE COUPLING MFRS INC.	39G	547	2.91 AC.
ELLA LLOYD & EDITH VINCI	451	664	2.81 AC.
THE WHEELING STEEL CORP.	27B	479	125.33 AC.
STARVAGGI INDUSTRIES	570	850	0.20 AC.