

# LOCATION PLAN PIEDMONT-FLUSHING ROAD S.H. 679 SEC. B & HOLLOWAY (PT) 1948

SCALE 1" = 200'

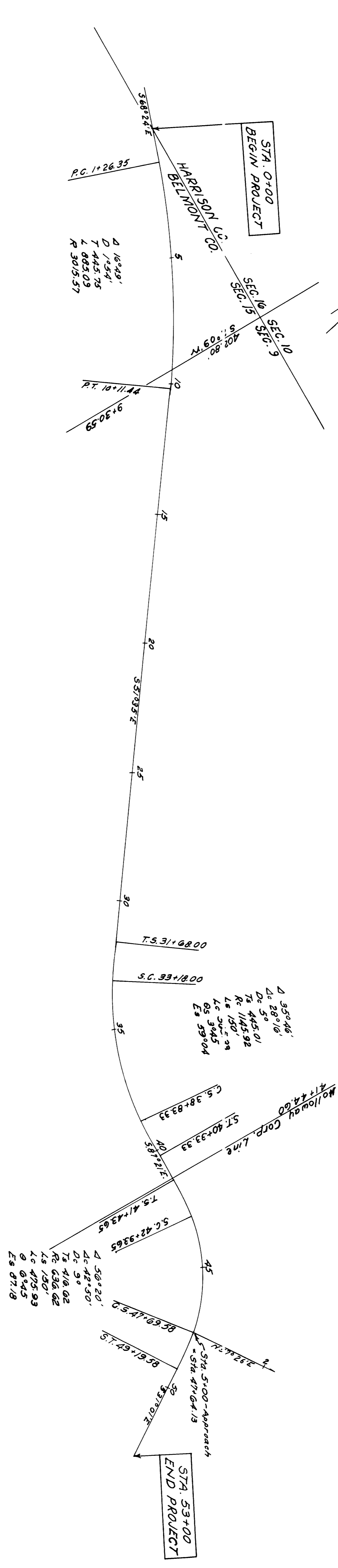

BELMONT COUNTY  
FLUSHING TOWNSHIP  
SEC. 5 15 & 9 T-10N R-6W

CENTER LINE REFERENCE MONUMENTS WILL BE SET BEFORE OR AFTER CONSTRUCTION

Sta. 0+00 Monument	Sta. 1+26.35 Monument	Sta. 20+00 Monument	Sta. 25+00 Monument	Sta. 31+68.00 Monument	Sta. 33+18.00 Monument	Sta. 38+03.33 Monument	Sta. 40+33.33 Monument	Sta. 41+43.65 Monument	Sta. 42+93.65 Monument	Sta. 53+00 Monument
I hereby certify that this plat is correct to the best of my knowledge and belief. Signed <u>ER. M. Galloway</u> Division Engineer Date <u>5-21-48</u>										

Received for Record JUN 2 1948  
 AT 12:37 P.M. O.C.L.O.C.K.  
 RECORDED JUN 23 1948  
 In Belmont County Record of  
 VOLUME PAGE  
 RECORDER

\$5.00 PAID  
 39127