

PORTION OF JEFFERSON STREET MADISON STREET AND ALLEYS TO BE VACATED BY THE CITY OF MARTINS FERRY

DATE - FEBRUARY, 1970
SCALE - 1 INCH = 20 FEET
SHRIVER & MCFARLAND - REG. SURVEYORS

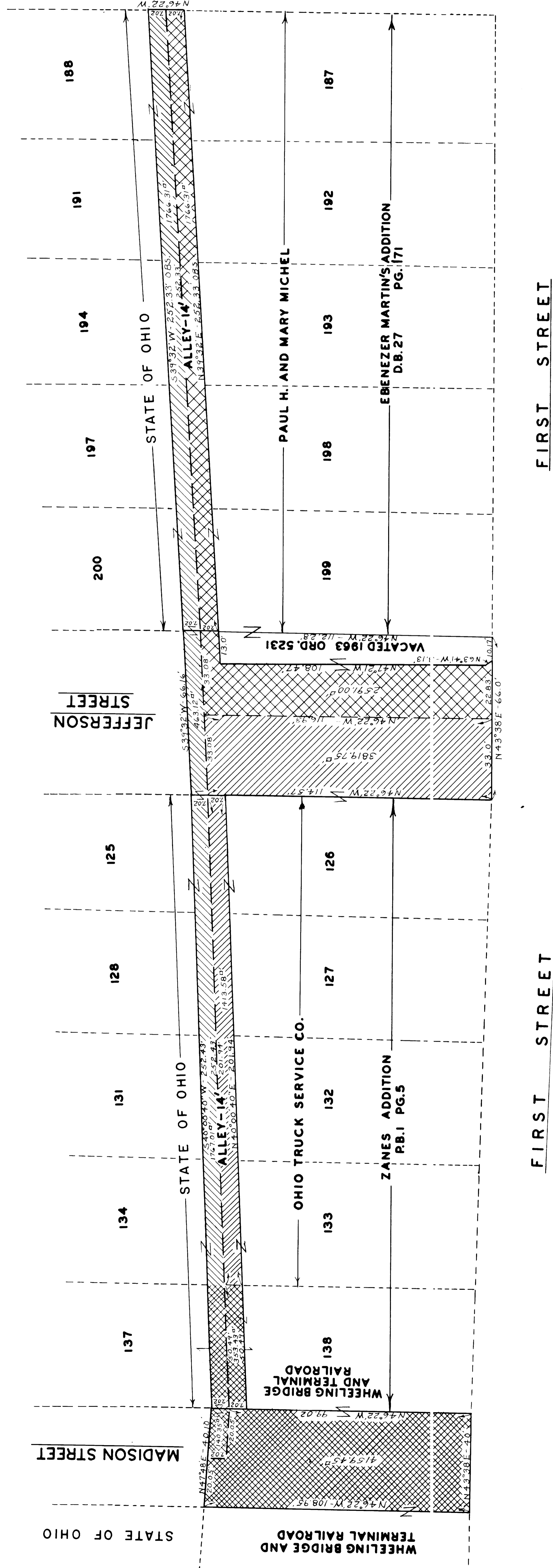
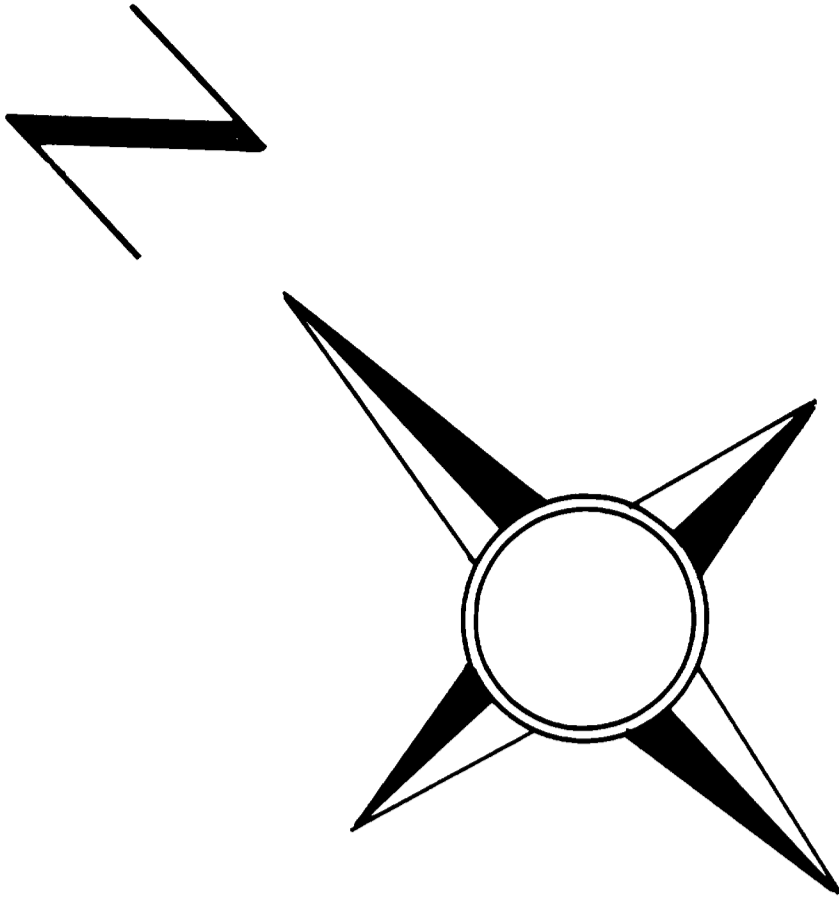

TOTAL AREAS VACATED	
STATE OF OHIO	4136.79 SQ. FT.
WHEELING BRIDGE AND TERMINAL RAILROAD	4512.66 SQ. FT.
OHIO TRUCK SERVICE CO.	5233.33 SQ. FT.
PAUL H. AND MARY MICHEL	4357.31 SQ. FT.
TOTAL	18,240.31 SQ. FT.

CITY OF MARTINS FERRY
PASSED BY ORDINANCE NO. 5902
THIS 28TH DAY OF FEBRUARY 1970.
James A. Shively
PRESIDENT OF COUNCIL

COUNTY ENGINEER
ACCEPTED FOR RECORD
DATE *July 31, 1970*
W. J. Hillert
COUNTY ENGINEER

COUNTY AUDITOR
APPROVED BY COUNTY AUDITOR
DATE *July 31, 1970*
PAID *By Andy Pink*
AUDITOR

COUNTY RECORDER
NO. 93793
RECEIVED FOR RECORD July 10
AT 11 O'CLOCK A.M.
RECORDED JULY 31 1970.
VOL. 13 PAGE 60
BELMONT COUNTY PLAT RECORDS
Alex B. Dumas
RECORDER
\$31.00 FEE PAID

THIS PLAT WAS PREPARED BY
SHRIVER & MCFARLAND - SURVEYORS
MARTINS FERRY

NOTE: RECORDED IN ACCORDANCE WITH SECTION
711.39 OF THE OHIO REVISED CODE.

REG. SURVEYOR NO. 4600.